

### Contents

Important User Information .....	2	Assembly .....	6
Safety Precautions .....	3	Operation .....	9
General Operation .....	3	Storage .....	11
Required Tools .....	4	Maintenance .....	11
Supplied Hardware .....	4	Replacement Parts .....	12
Parts List .....	5		



Visit the OnBoard Percussion Cart web page at [wengercorp.com](http://wengercorp.com) for more information.

**Note:** Please read and understand these instructions before proceeding.  
**Note:** If you need additional information, contact Wenger Corporation using the information below.

# ***Important User Information***

---

## ***General***

Copyright © 2024 by Wenger Corporation

All rights reserved. No part of the contents of this manual may be reproduced, copied, or transmitted in any form or by any means including graphic, electronic, or mechanical methods or photocopying, recording, or information storage and retrieval systems without the written permission of the publisher, unless it is for the purchaser's personal use.

Printed and bound in the United States of America.

The information in this manual is subject to change without notice and does not represent a commitment on the part of Wenger Corporation. Wenger Corporation does not assume any responsibility for any errors that may appear in these instructions.

In no event will Wenger Corporation be liable for technical or editorial omissions made herein, nor for direct, indirect, special, incidental, or consequential damages resulting from the use or defect of these instructions. The manufacturer reserves the right to change this product at any time.

The information in this document is not intended to cover all possible conditions and situations that might occur. The end user must exercise caution and common sense when assembling or installing Wenger Corporation products. If any questions or problems arise, call the Wenger Corporation at (800) 4WENGER (493-6437) or +1-507-455-4100 worldwide.

## ***Manufacturer***

The OnBoard® Percussion Cart is manufactured by:

Wenger Corporation  
555 Park Drive  
Owatonna, MN 55060  
(800) 4WENGER (493-6437) • +1 (507) 455-4100  
wengercorp.com

## ***Intended Use***

- This product is intended for indoor use in normal ambient temperature and humidity conditions – it must not be exposed to prolonged outside weather conditions.
- This product is intended to be assembled, installed and used only as described in these instructions.

## ***Warranty***

Warranty information is available at [wengercorp.com](http://wengercorp.com).

## Safety Precautions

---

Throughout this document you may find cautions and warnings which are defined as follows:

- **WARNING:** Failure to follow the instruction could result in serious injury or damage to property.
- **CAUTION:** Failure to follow the instruction could result in minor injury or damage to property.

Read and understand all of these safety instructions before any assembly, installation or use.

### **⚠ CAUTION**

*Make sure anyone assembling, installing or using this product has read and understands these instructions.*

### **⚠ CAUTION**

*Failure to comply with Warnings and Cautions in this document or on the equipment can result in damage to property or serious injury.*

## General Operation

### **⚠ CAUTION**

- *OnBoard Percussion Cart maximum total load capacity is 150 lb (68 kg) uniformly distributed on the main support bar.*
- *Each instrument support is limited to a maximum load of 20 lb (9 kg) if used in the vertical position and 10 lb (5 kg) in the horizontal position.*
- *Instruments or accessories mounted on the 3/4" (19 mm) diameter instrument support bar must be secure and positioned so the cart is stable and there are no dangerous protruding edges or surfaces.*
- *When the cart is left unattended, it must be placed in a secure position so that it doesn't move or roll into vehicles, structures or people.*
- *All four casters must be in contact with the floor or ground at all times.*
- *Always distribute the weight evenly on the cart. Avoid top-heavy loading.*
- *Avoid ramps with a rise or drop steeper than a 1' (305 mm) in a 12' (3658 mm) horizontal distance.*
- *Always move slowly up or down a ramp with the narrow end of the cart in the direction of travel.*
- *Do not pull or push too high on the cart or pull or push on the sides of the cart which may cause the cart to tip over.*
- *Avoid off-center loads which may cause the cart to tip over.*
- *Because swivel casters move in any direction, the operator must move the cart slowly and have a clear view to avoid obstructions and individuals standing in the direction of travel.*
- *If the cart is heavily loaded, two people are always required to move the cart (one pushing at the rear and one guiding at the front).*
- *When transporting this product in a vehicle, it must be braced with tie-downs, chains or cargo straps designed specifically to prevent the cart from moving.*
- *Blankets or other padding material may be required to avoid damage to the cart and accessories from vibration and impact during transport.*
- *Do not transport people or stand on the keyboard cart.*
- *When moving the cart do not ride on the cart and do not allow others to ride on the cart.*
- *Use caution when removing objects from the cart or when placing objects on the cart.*
- *When towing the cart, do not exceed 5 mph (8 kph) or tow more than three carts together.*
- *When towing the cart, avoid tight turns which may result in the tow vehicle making contact with the cart or tow bar.*

## **Required Tools**

---

- 9/16" Wrench or 9/16" socket with ratchet
- 1/2" Wrench or 1/2" socket with ratchet
- 3/16" Allen wrench (provided)

## **Supplied Hardware**

---

*Hardware remaining after assembly can be discarded.*

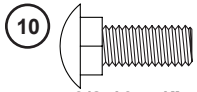

10  
3/8-16 x 1"  
Carriage Bolt

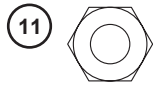

11  
3/8-16  
Lock Nut

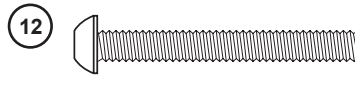

12  
5/16-18 x 3"  
Socket Screw

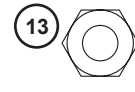

13  
5/16-18  
Nylon Lock Nut

# Parts List

Item	Description	Item	Description
1	Base Assembly	6	Mount Assembly
2	Swivel Caster	7	Support Weldment
3	Rigid Caster	8	Tube Clamp Extrusion
4	Tow Bar	9	Accessories Clamp Extrusion
5	Curved Tube Extrusion		

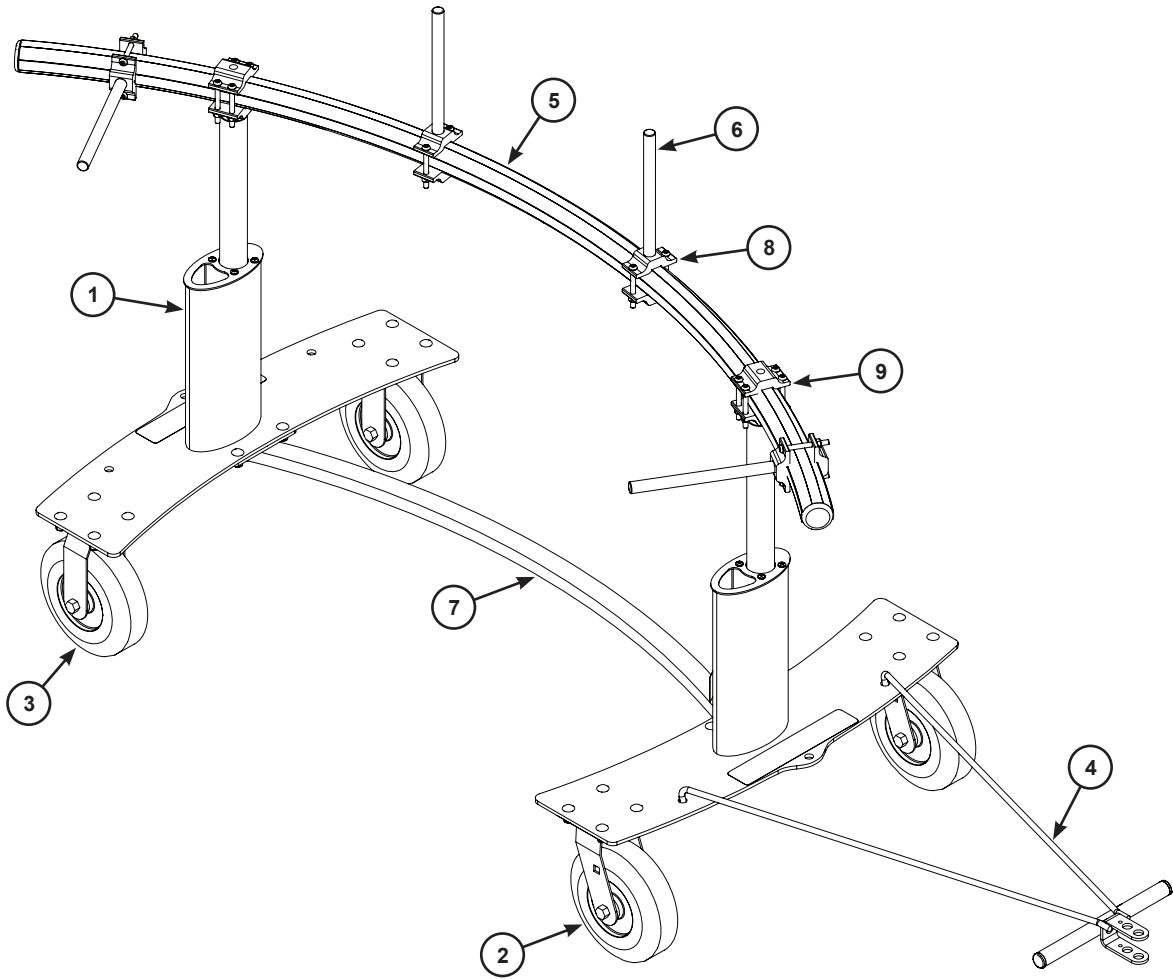

# Assembly

## Assemble Casters to the Base Assembly

1. Align the swivel casters (2) with the bolt holes on the base assembly (1).
2. Assemble the casters to the base assembly (1) using two 3/8-16 x 1" carriage bolts (10) and lock nuts (11). **(Detail A)**

### NOTICE

**The same caster type (swivel or rigid) must be assembled to each base assembly.**

3. Align the rigid casters (3) with the bolt holes on the remaining base assembly (1).
4. Repeat step 2.

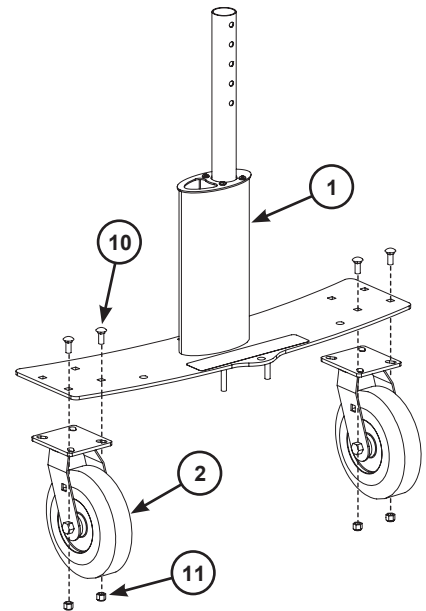

Detail A

## Assemble the Support to the Base Assemblies

5. Lay the base assemblies on end.
6. Align the cross member (7) to the bolt holes located on inside the base assemblies. **(Detail B)**
7. Secure the support to the base assemblies using 3/8-16 x 1 carriage bolts (10) and 3/8" lock nuts (11).

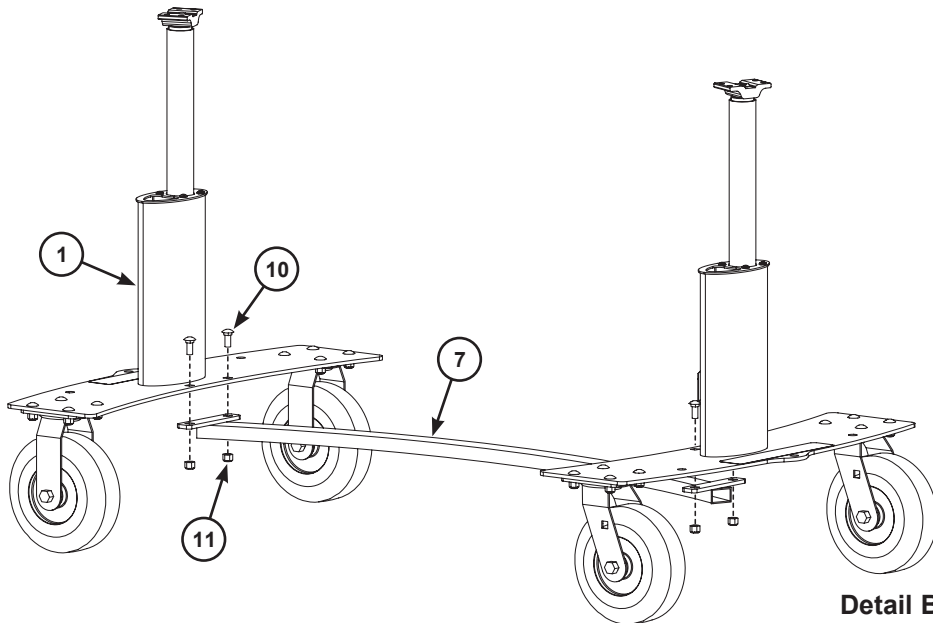

Detail B

## Assembly (continued)

### Assemble the Curved Tube Extrusion Onto the Cart Base

#### NOTICE

**Make sure the cart is secure and doesn't roll away while assembling the curved tube extrusion (5).**

- Place the curved tube extrusion onto the clamps located at the top of the base assemblies (1). Be sure to center the curved tube extrusion so it is evenly positioned on the base units. **(Detail C)**
- Place the accessory clamp extrusion (9) parallel to the clamp located on the base assembly.
- Using socket screw, 5/16-18 x 3" (12) and nylon lock nut, 5/16-18 (13), tighten the tube clamp extrusions together securing the curved tube extrusion.

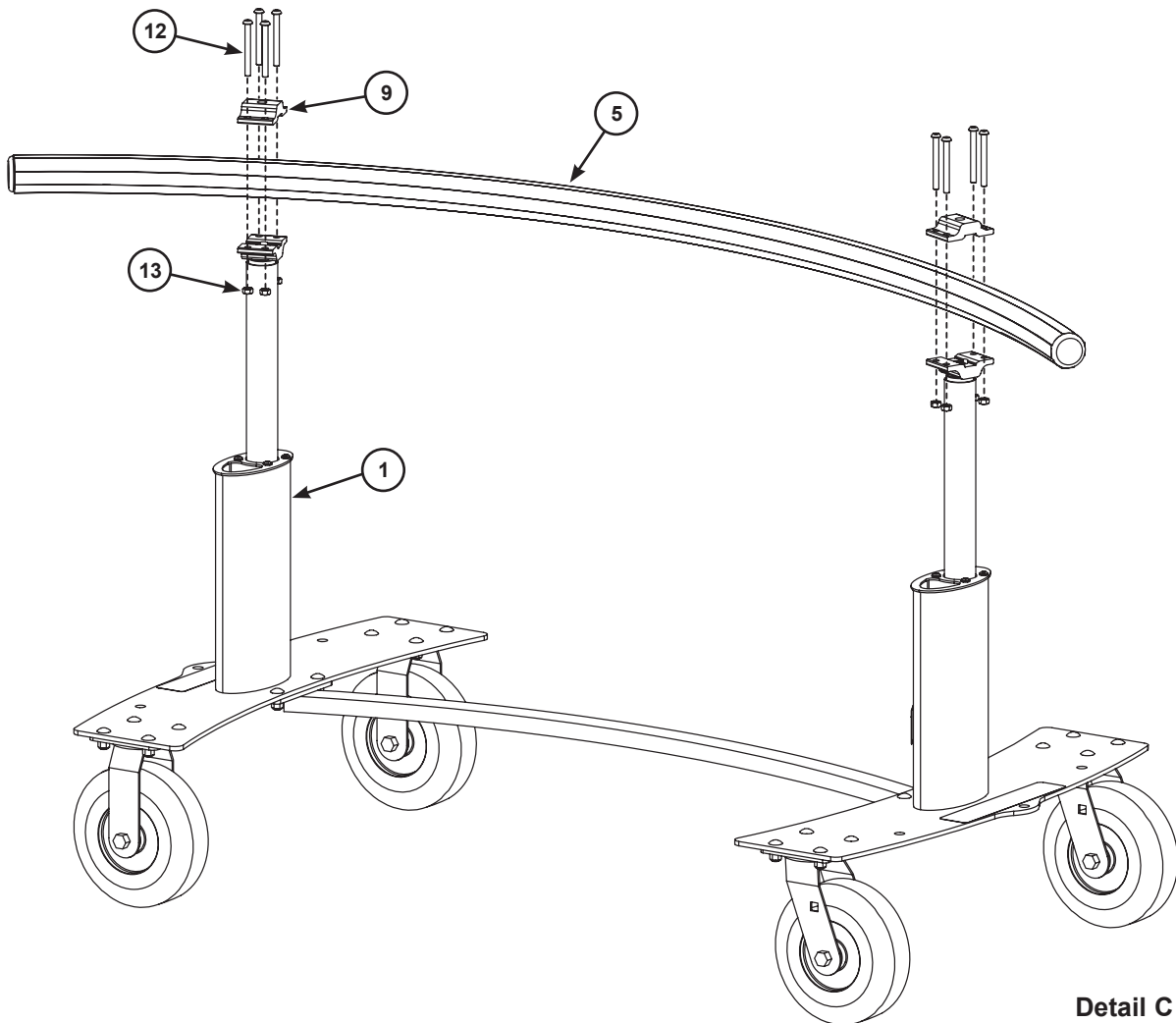

## **Assembly (continued)**

---

### **Attachment of Percussion Mount Assembly**

The percussion mount assembly may be attached in the up, down, front or back position to receive universal instrument mounts. Determine the direction in which the instruments are to be located on the cart.

To attach the percussion mount assembly; **(Detail D)**.

11. Place the percussion mount assembly (6) and tube clamp extrusion (8) parallel to each other at the desired location, on the curved tube extrusion (5).
12. Insert the 5/16-18 x 3" socket screw (12) into the percussion mount assembly (6) and through the tube clamp extrusion (8).
13. Using the 5/16-18 lock nut (13) tighten the percussion mount assembly (6) onto the curved tube extrusion (5) uniformly. Do not over-tighten.

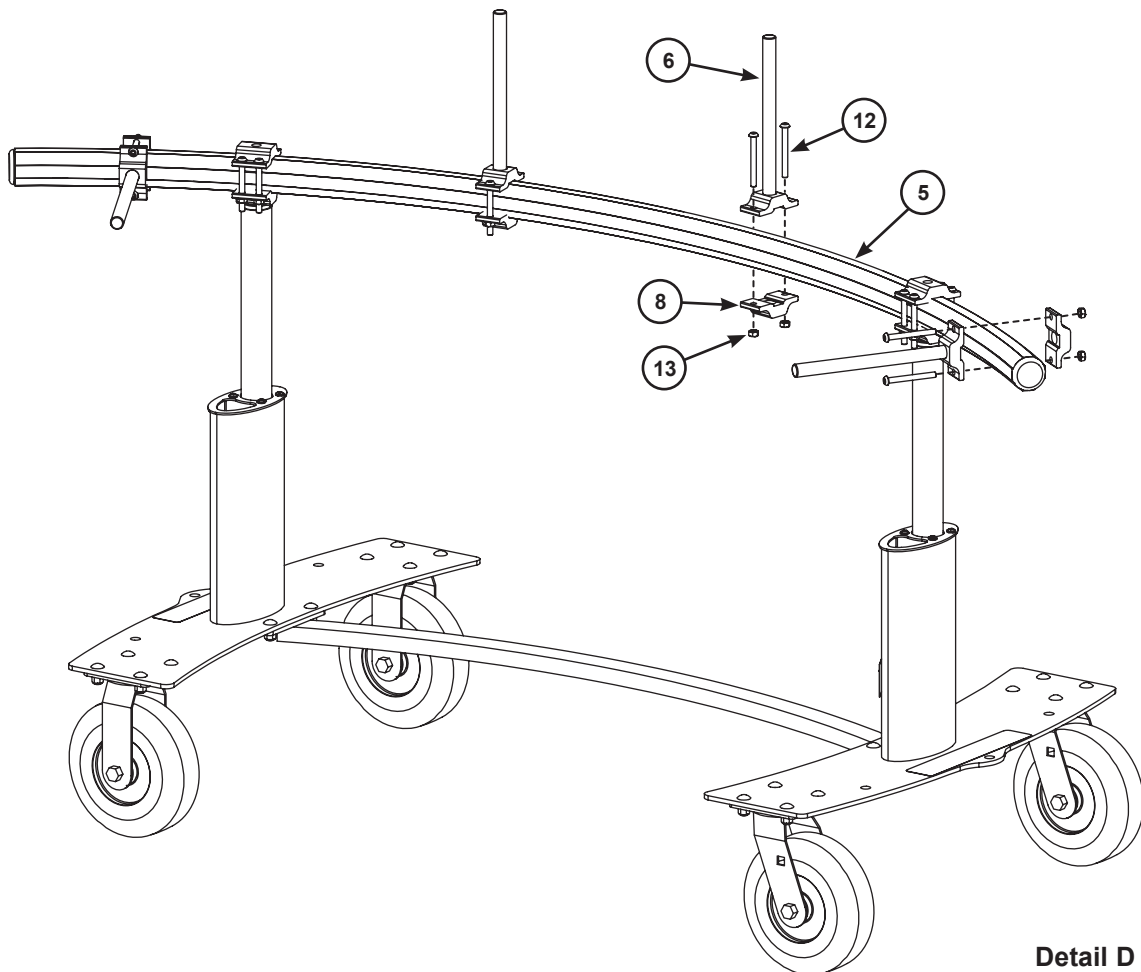



## Operation

---

Always observe the "Safety Precautions" in these instructions.

**Failure to comply with the "Safety Precautions" in these instructions can result in serious injury.**

### Loading the Percussion Cart

1. Always distribute loads evenly.
2. Avoid off-center loads.

### Moving the Percussion Cart

1. When the cart is left unattended, it must be placed in a secure position to avoid moving or rolling into vehicles, structures or people.
2. When pulling or pushing the cart, always pull or push at about waist level or lower. Pushing above the main support bar can tip the cart over. **(Detail A)**
3. If the cart is heavily loaded, two people should always work together to move the cart in the direction of travel that the rigid casters can move freely. One person pushing at the rear and one person guiding at the front. Take care to avoid stationary objects or people standing in the path of the cart.

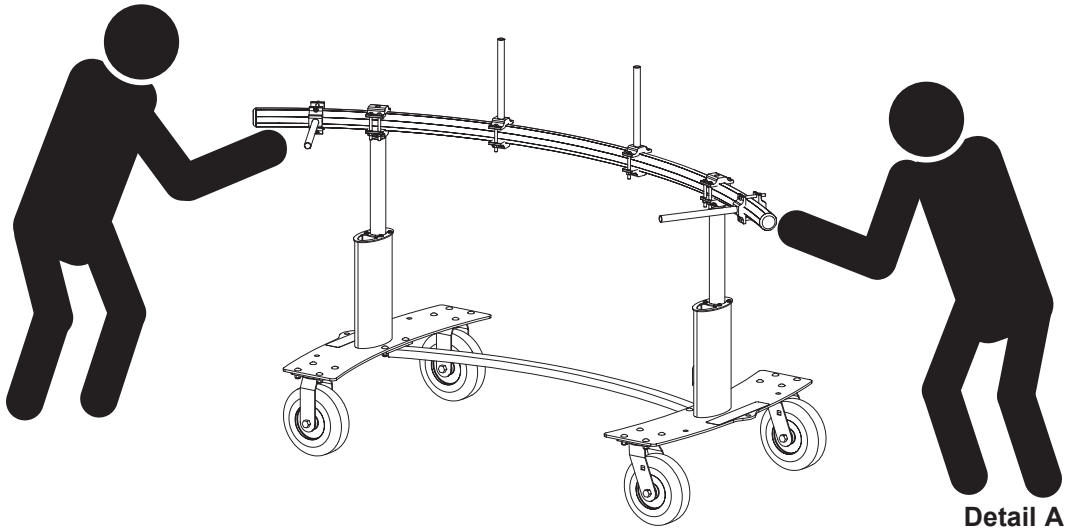

### **CAUTION**

**Do not transport people  
or stand on the cart.**

## Operation (continued)

---

- A separate tow bar (4) is provided that inserts into two holes in the percussion cart base (1). The tow bar (4) may also be used as a handle to pull the cart manually or can be attached horizontally to a lawn and garden tractor. **(Detail B)**

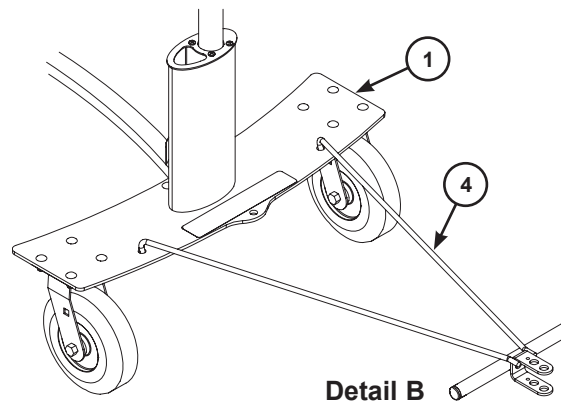

### **CAUTION**

*When towing the cart do not exceed 5 mph (8 kph) or tow more than three carts together.*

### **CAUTION**

*When towing the cart, avoid tight turns which may result in the tow vehicle making contact with the cart or tow bar.*

- When the tow bar is removed, store it out of the way so that it is not an obstruction or hazard.
- If the cart is transported in a vehicle, it must be braced or strapped to the vehicle so that it cannot move. Bracing must use tie-downs or straps specifically designed to prevent the cart from moving in the vehicle. Remove objects or instruments that may be damaged during transport. Secure cart at the lower frame. Pads or other protection against abrasion may be required.

## **Storage**

---

When leaving the cart in a stationary position or in storage, block or secure casters to prevent the cart from moving and possibly causing damage.

## **Maintenance**

---

1. Clean the cart with a mild detergent and warm water. Avoid using harsh or abrasive cleaning products.
2. Immediately replace any caster wheels that do not rotate or turn freely.
3. Immediately replace or repair any tire that develops a flat area.
4. Recommended tire pressure is 50 psi (344 kPa). Do not exceed the maximum tire pressure shown on the sidewall of the tire.
5. During heavy usage, periodically check and tighten item #4 for the clamp extrusions holding the curved extrusion.
6. Check all fasteners to be certain they are secure before use.
7. Grease zerks and bushings if required.

# Replacement Parts

Item	Description	Item	Description
1	Percussion Cart Base Assembly	12	5/16-18 x 3" Socket Screw
2	9" (229 mm) Dia Swivel Caster	13	5/16-18 Lock Nut
3	9" (229 mm) Dia Rigid Caster	14	1/4-20 x 3/4" Torx Self Tap Screw
4	Tow Bar	15	Extrusion Cap
5	Curved Tube Extrusion	16	Upright Extrusion
6	Percussion Mount Assembly	17	Wenger Onboard Decal
7	Percussion Cart Support	18	2.00 Plug
8	Tube Clamp Extrusion	19	1/4" Lock Washer
9	1/2-13 x 1" Socket Screw	20	1/4-20 x 1-1/4" Self Tap Screw
10	3/8-16 x 1" Carriage Bolt	21	Accessory Clamp Extrusion
11	3/8-16 Lock Nut		

